





CENTRAL HISTORIC STATELY

Rich in history and aesthetics, this Greek Revival masterpiece accommodates everything from VIP corporate parties, galas, and grand weddings in the heart of downtown San Francisco. Only minutes away from the Moscone Center, it's been renovated to accommodate modern functions without losing any of its historical grandeur. With 100,000 square feet of ballrooms, gold vaults, and gaslight chandeliers, its ambience guarantees a vibe that will take you back to a more regal time.



CAPACITY

LOCATION	CAPACITY	SQUARE FEET
Full Venue	999	52,000
Main Floor	700	20,640
Vault Level	299	20,640



DIMENSIONS

CEILING HEIGHT	30'
LOADING DOOR	W: 5'9" x H: 9'9"
MAIN ENTRANCE	W: 5'7" x H: 12'10"
ADA/FREIGHT ELEVATOR	W: 3'4" x H: 7'10"



DETAILS

ADDRESS

88 5th Street, San Francisco, CA 94103

POWER

Dedicated 400 amp circuit + 100 and 60 amp circuits

WI-FI

Up to 1 Gbps

PARKING

Public parking garage at 5th Street and Mission

PUBLIC TRANSPORTATION

Half a block from Powell & Market Subway Station

VENDORS

Ask for our list of preferred vendors

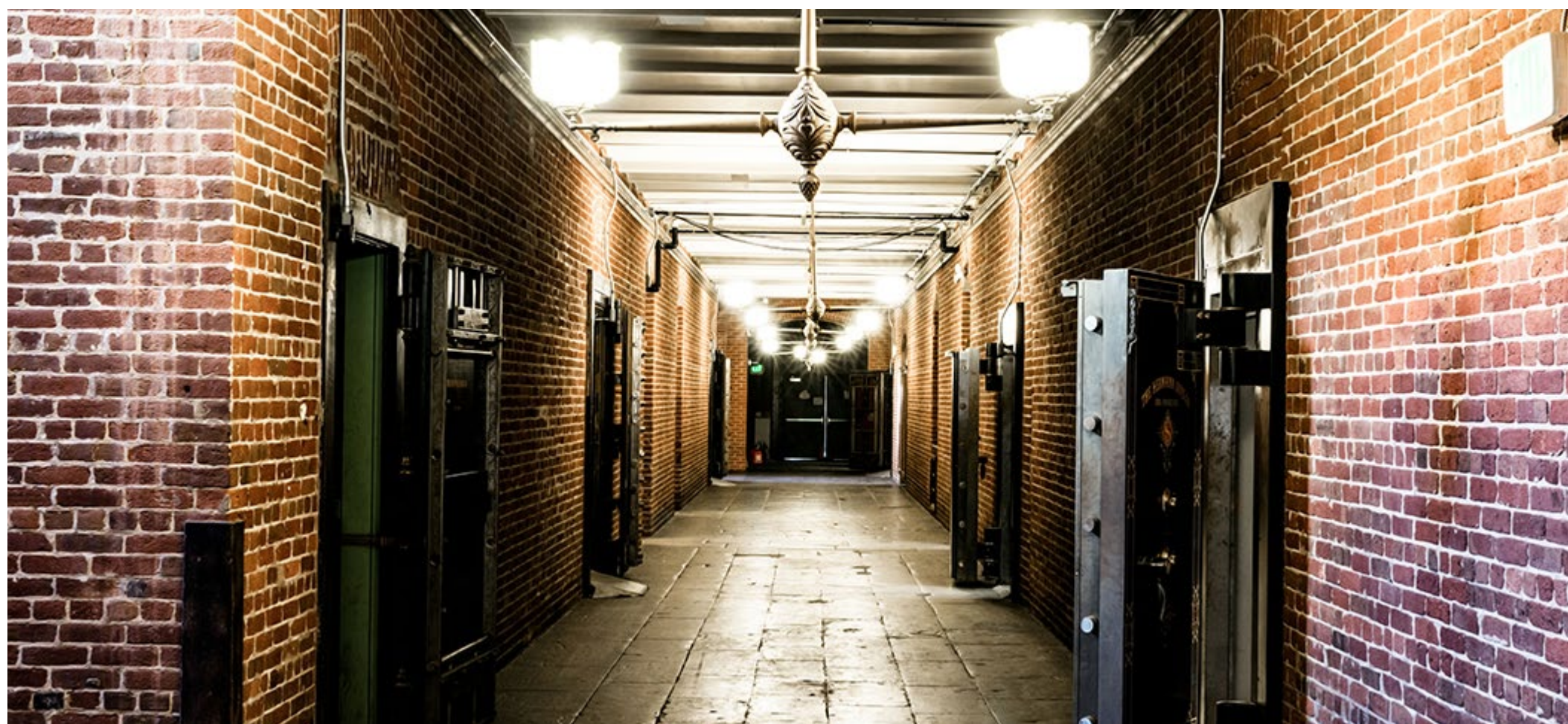

FLOORPLAN

VAULT LEVEL

LOCATION	SQUARE FOOTAGE	DIMENSIONS (W X L)	STANDING
Vault 1 (Sealed)	N/A	N/A	0
Vault 2	247	19' x 13'	35
Vault 3	234	18' x 13'	33
Vault 4	240	12' x 20'	34
Vault 5	323	19' x 17'	46
Vault 6	493	17' x 29'	49
Vault 7	340	20' x 17'	48
Guard's Station	280	10' x 28'	40
Guard's Lounge	841	29' x 29'	
Granite Niche	890	N/A	49

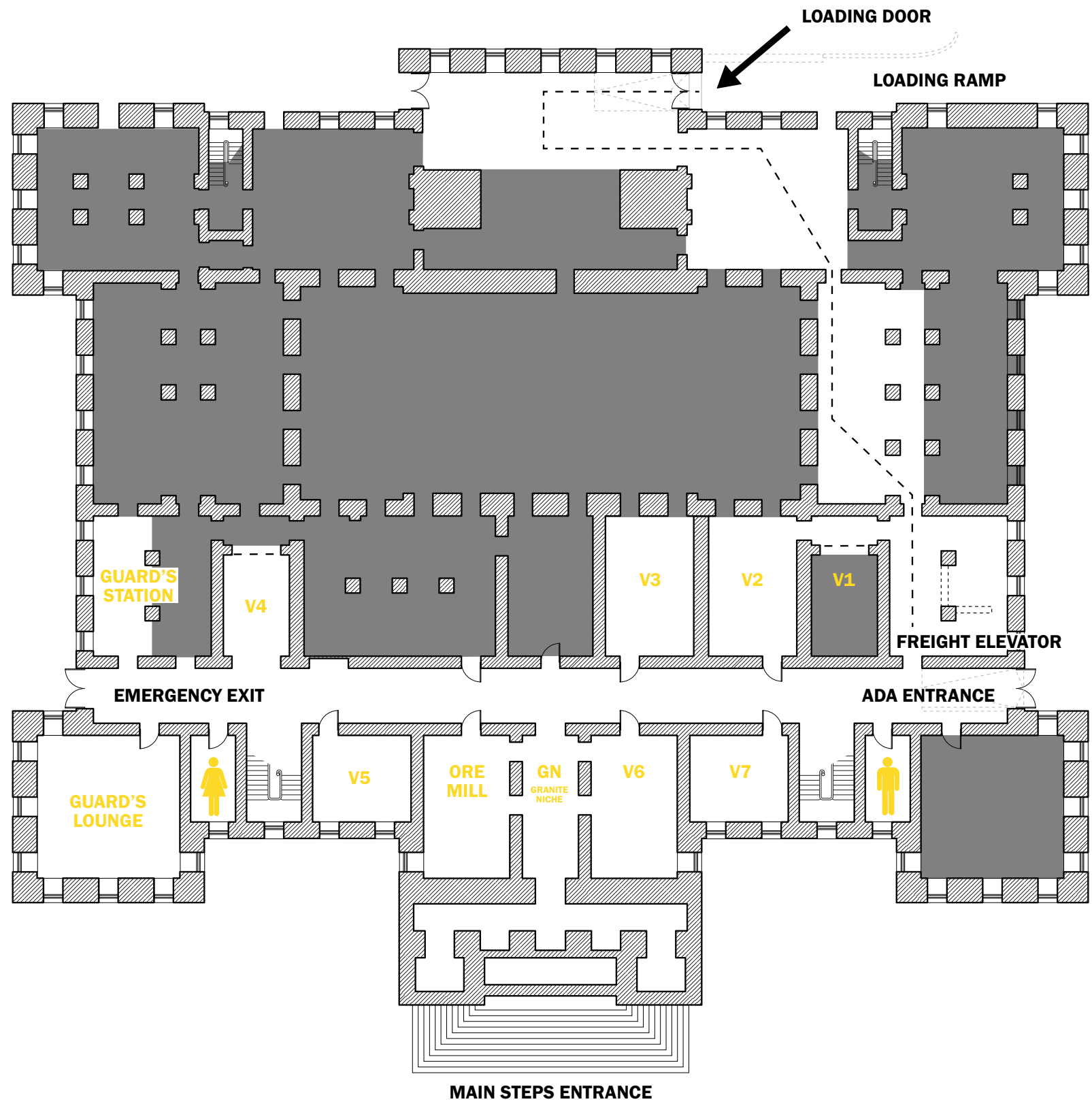

FLOORPLAN

MAIN FLOOR

LOCATION	SQUARE FOOTAGE	DIMENSIONS (W X L)	STANDING	SEATED
Gold Ballroom	1,160	40' x 29'	165	77
Mint Ballroom	1,160	40' x 29'	165	77
Column Ballroom	1,755	39' x 45'	250	117
Banker's Ballroom	1,755	39' x 45'	250	117
Courtyard	3,900	100' x 39'	350	260
Weigh Room	696	24' x 29'	99	46
Prospector's Lounge	957	33' x 29'	136	63
Coiner's Office	899	29' x 29'	49	49
Treasurer's Office	899	31' x 29'	49	49
Grand Hallway	2,068	188' x 11'	-	-
Vault	266	14' x 19'	38	17
Salon 1	378	21' x 18'	49	25
Salon 2	522	18' x 29'	74	34
Salon 3	522	18' x 29'	74	34
Salon 4	378	21' x 18'	49	25
Miner's Room	696	24' x 29'	90	50
Lobby		12' x 31'		
Foyer		17' x 20'		

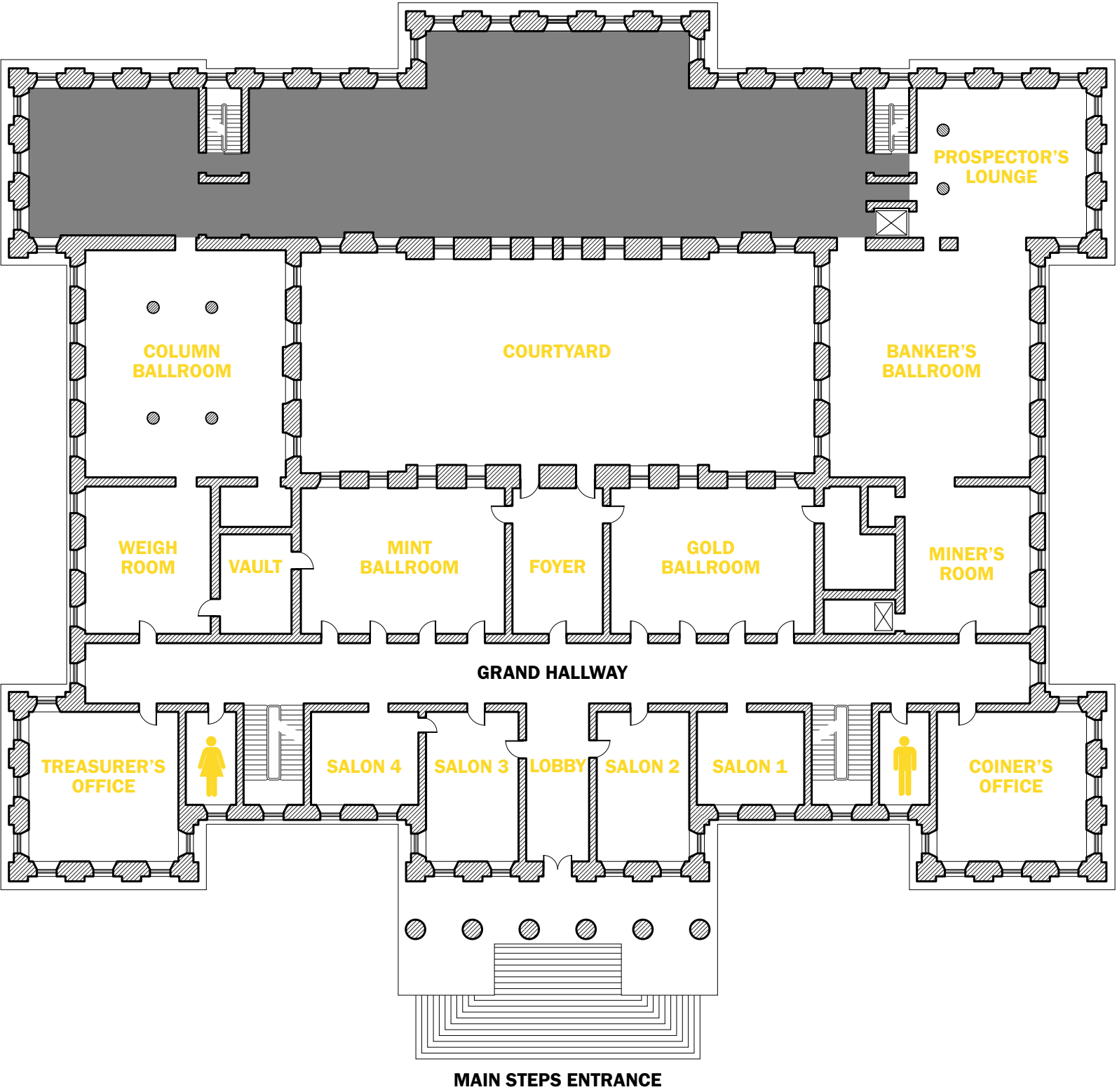

+ THE PLUS FACTOR

Non Plus Ultra curates the most unique locations for unparalleled events of all sizes. Our venue portfolio spans from historically charming to modernly chic, and each of our offerings can be tailored to go beyond all expectations of what an event can be.

As one of the country's leading venue activation firms, Non Plus Ultra can turn any event into milestone. Our experts use decades of combined experience to uncover the perfect space for your engagement, and then help you refine each and every detail that will make it shine beyond everyone's expectations.

Bask in the historical grandeur when you have your next event at the San Francisco Mint. Ready to book? Contact our venue specialists to check availability.

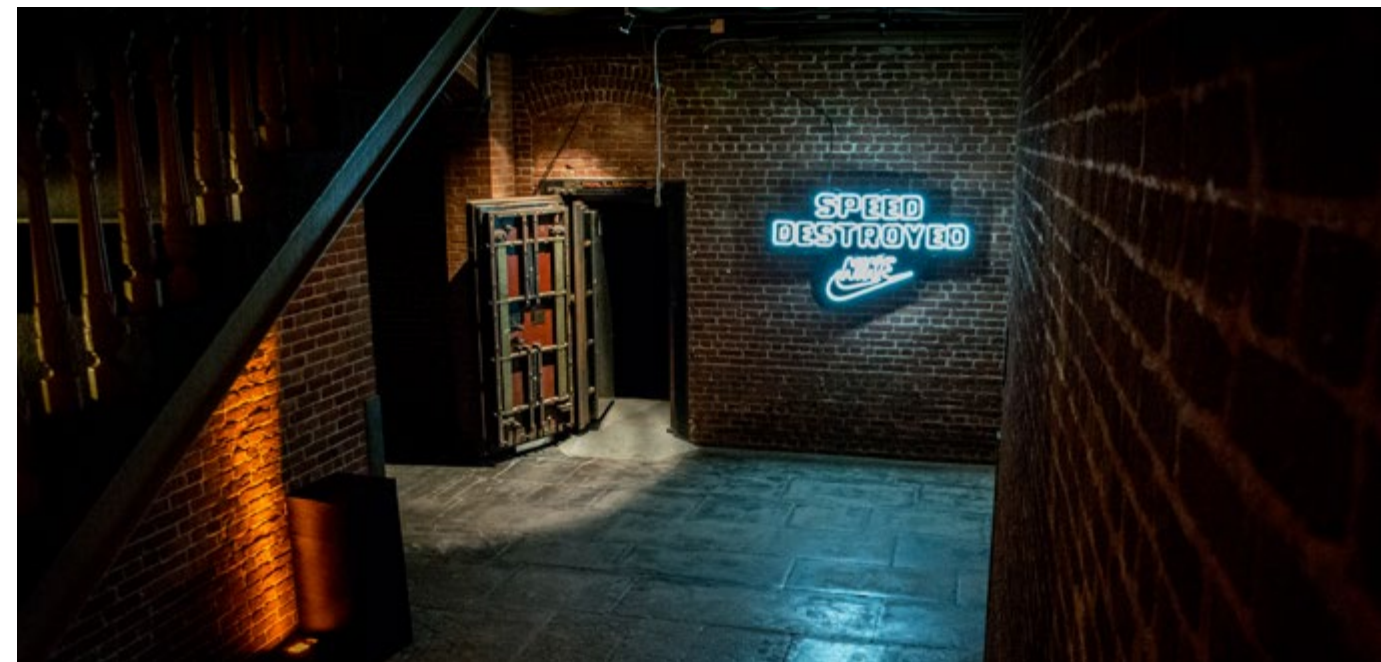

BOOKINGS

415 649 8356

events@nonplusultrainc.com

thesanfranciscoint.com

88 5th Street
San Francisco, CA
94103

